

# Eutectic Bodies Maintenance Checklist

## Checkliste für die Regelmäßige Wartung

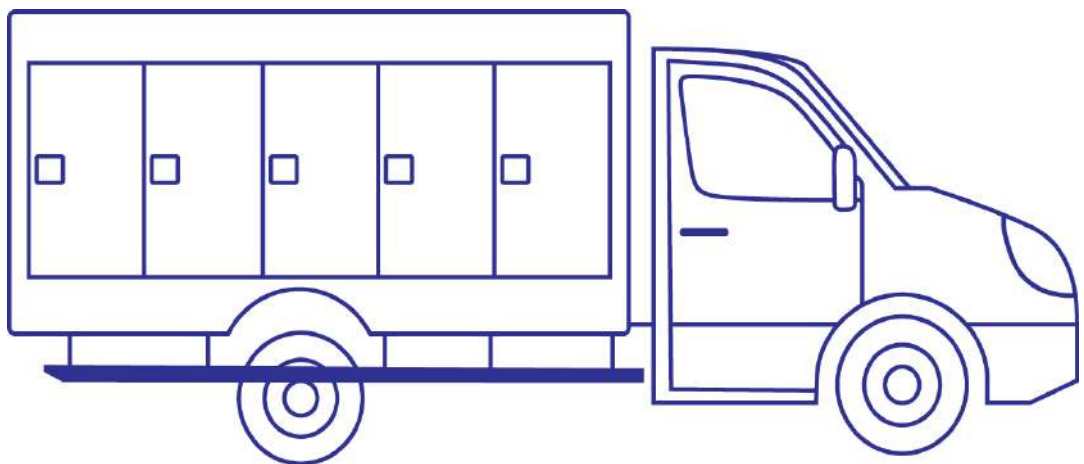

EN | DE | RU | DK | SE | NO | FI |

NL | ES | RO | PL | LT



# Carlsen Baltic

## TWICE A WEEK

### Remove ice from eutectic plate surface

Use plastic ice scraper. Never allow the layer of frost to become more than 20 mm thick.

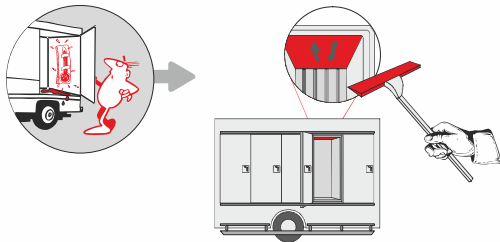

## MONTHLY

### 1 Clean ice and dirt residue from door frame

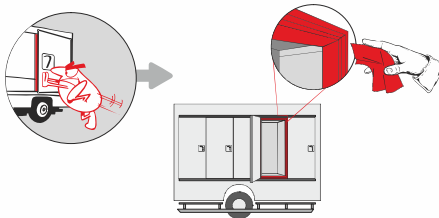

### 2 Spray gasket

Using lubricant ■

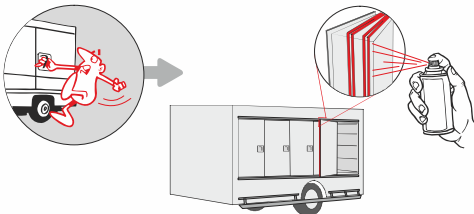

## EVERY 3 MONTHS

### 1 Defrost body

### 2 Lubricate

Using lubricant ■

#### a) Door lock and screw

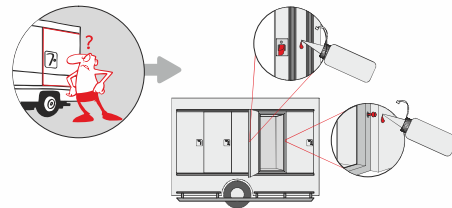

#### b) Locking cylinder

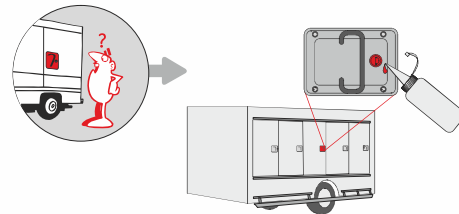

#### c) Central lock (moving parts)

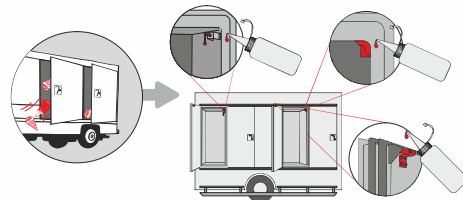

■ - Wurth Silicone Spray No. 0893 221 (or equivalent from another manufacturer) is recommended.

■ - Wurth Foodstuffs HHS No. 0893 107 6 (or equivalent from another manufacturer) is recommended.

**Carlsen Baltic UAB**  
Sales. Service. Spare Parts.

\ T: +370 37 407343 \ [info@carlsenbaltic.com](mailto:info@carlsenbaltic.com) \ [carlsenbaltic.com](http://carlsenbaltic.com)



# Carlsen Baltic

## 2 MAL WÖCHENTLICH

### Eutektische Platten enteisen

Den Eiskratzer aus Kunststoff verwenden.  
Die Frostschrift sollte niemals mehr als 20 mm dick werden.

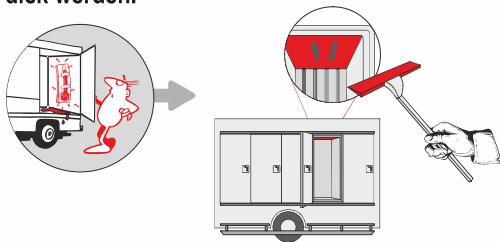

## MONATLICH

### 1 Eis- und Schmutzreste vom Türrahmen entfernen

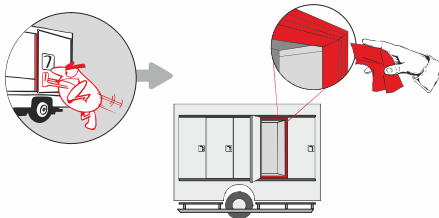

### 2 Türgummis einsprühen

mit Schmiermittel ■

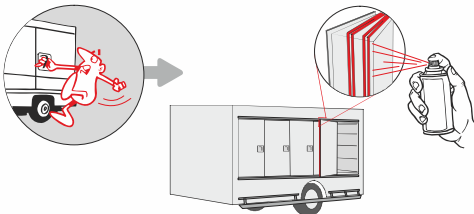

## ALLE 3 MONATE

### 1 Kühllaufbau abtauen

### 2 Schmieren

mit Schmiermittel ■

#### a) Türschlösser und Schließkeile

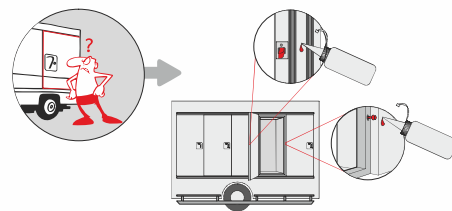

#### b) Schließzylinder

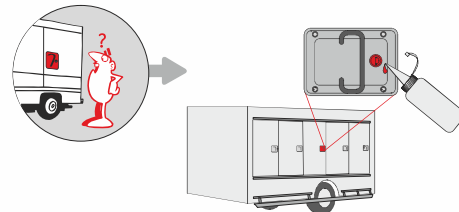

#### c) Zentralverriegelung (bewegliche Teile)

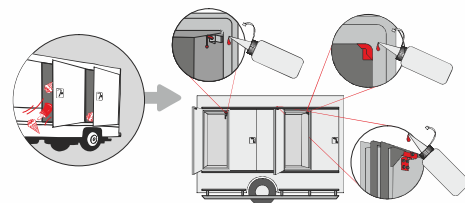

■ – Würth Silikon-Spray Art.-Nr. 0893 221 (oder entsprechendes Mittel von einem anderen Hersteller) ist zu empfehlen.

■ – Würth Lebensmittel HHS Art.-Nr. 0893 107 6 (oder entsprechendes Mittel von einem anderen Hersteller) ist zu empfehlen.

Carlsen Baltic UAB \ T: +370 37 407343 \ info@carlsenbaltic.com \ carlsenbaltic.com



# Carlsen Baltic

## ДВАЖДЫ В НЕДЕЛЮ

### Очистьте поверхность эвтектических плит от льда

Используйте пластиковый скребок для очистки плиты. Никогда не допускайте, чтобы слой льда стал толщиной более 20 мм.

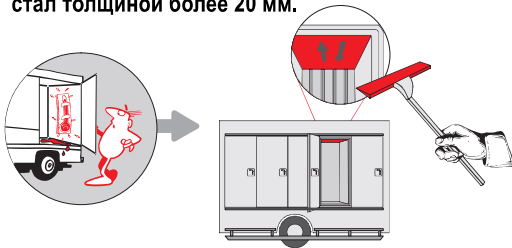

## ЕЖЕМЕСЯЧНО

### 1 Очистьте двери от грязи и льда

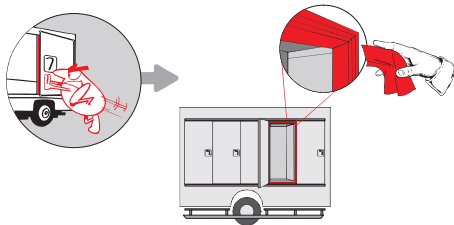

### 2 Смажьте уплотнители двери

Используйте спрей ■■■

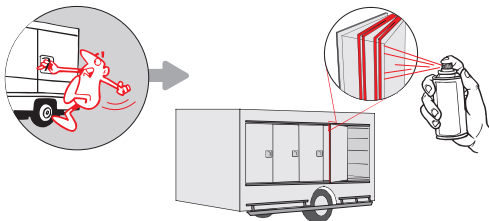

## КАЖДЫЕ 3 МЕСЯЦА

### 1 Разморозьте фургон

### 2 Смажьте детали замка

Используйте силикон ■■■■

#### а) Язычок замка

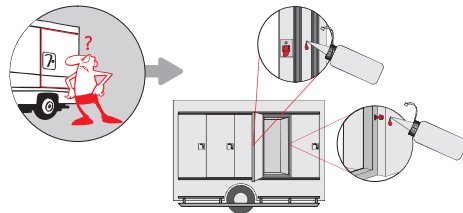

#### б) Сердцевина замка

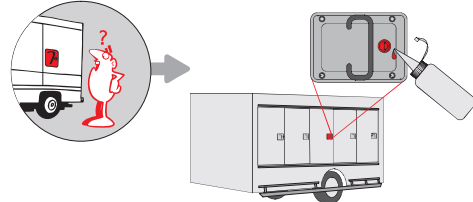

#### в) Движущиеся части центрального замка

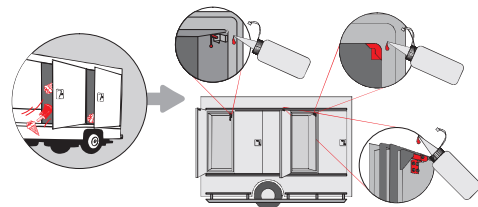

■■■ – Wurth Silicone Spray No. 0893 221 или его аналог

■■■■ – Wurth Foodstuffs HHS No. 0893 107 6 или его аналог



# Carlsen Baltic

## 2 GANGE UGENTLIGT

### Fjern is fra loftet og døre

Brug plastisk isskraber. Lad aldrig frostlaget blive mere end 20 mm tykt.

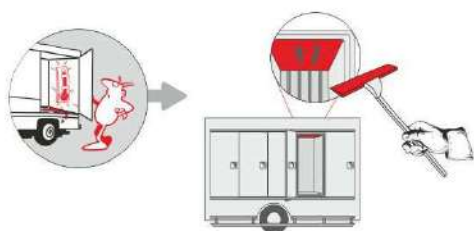

## MÅNEDLIGT

### 1 Rengør is og snavsrester fra dørkarmen

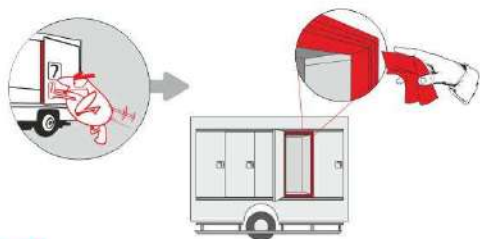

### 2 Sprøjt gummipakninger

Brug silicone ■

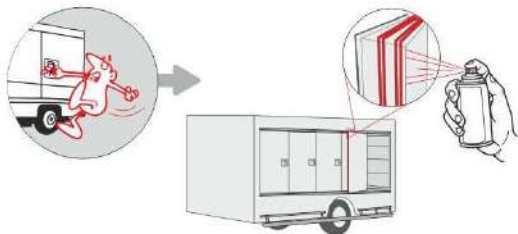

## HVER 3 MÅNEDER

### 1 Afrimning af frysekasse

### 2 Smør

Brug silicone ■

#### a) Dørlåse og skrue

(Würth 08931076)

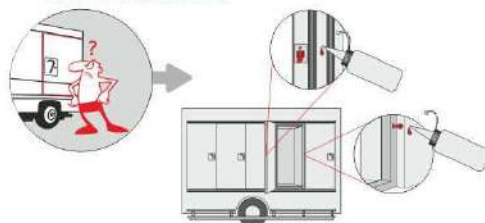

#### b) Låsecylinder

(Würth 08931076)

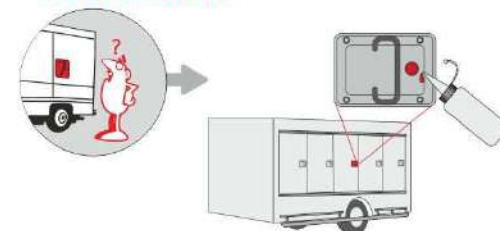

#### c) Centrallås

(bevægelige dele)

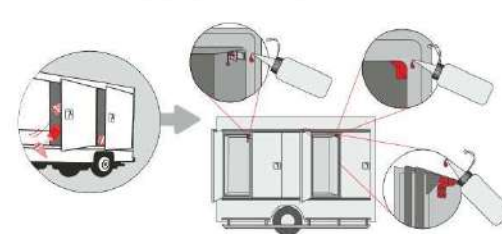

■ Würth silikonespray nr. 0893221 (eller tilsvarende) anbefales til gummilister.

■ Würth fødevarer HHS nr. 08931076 (eller tilsvarende) anbefales.

Carlsen Baltic UAB

Salg. Service. Reservedele.

\ T: +370 37 407343 \ info@carlsenbaltic.com \ carlsenbaltic.com



# Carlsen Baltic

## TVÅ GÅNGER I VECKAN

### Borttagning av is på kylplattorna

Använd plastskrapa. Låt aldrig frostsiktet bli mer än 2 cm tjockt.

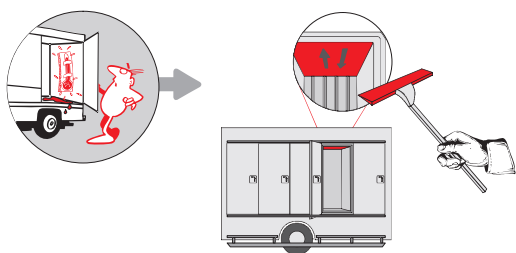

## VARJE MÅNAD

### 1 Rengöring av is och smuts på dörrlistar

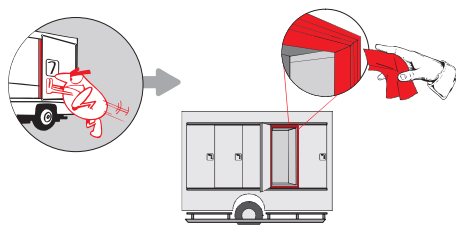

### 2 Smörj skåplister

Med smörjmedel ■

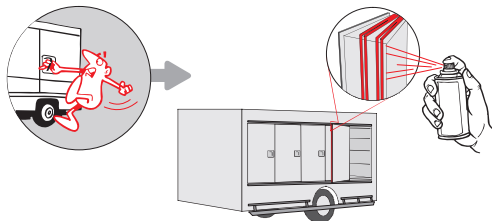

## VAR TREDJE MÅNAD

### 1 Avfrostning av skåp

### 2 Smörjning

Med smörjmedel ■

#### a) Dörrlås och skruv

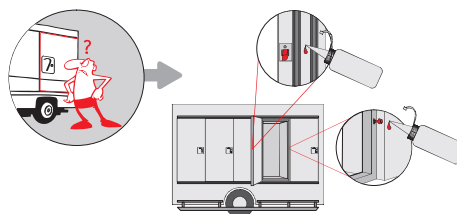

#### b) Låscylinder

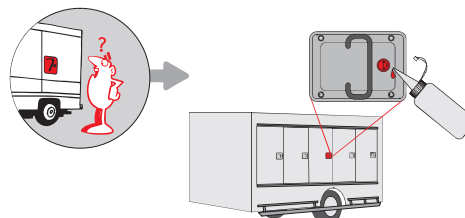

#### c) Centrallås (rörliga delar)

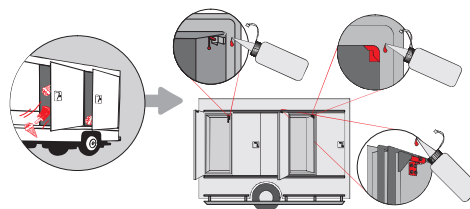

■ – Würth Silikonspray Art nr. 0893 221 rekommenderas (eller motsvarande från en annan tillverkare).

■ – Würth Foodstuffs HHS Art. Nr. 0893 107 6 rekommenderas (eller motsvarande från en annan tillverkare).

Carlsen Baltic UAB | T: +370 37 407343 | info@carlsenbaltic.com | carlsenbaltic.com  
Försäljning, Service, Reservdelar.



# Carlsen Baltic

## TO GANGER I UKEN

### Fjern is fra overflaten av platene

ved hjelp av en plast is skrape. La aldri frostlaget bli mer enn 20 mm tykt.

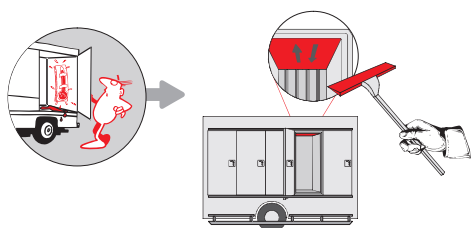

## HVER MÅNED

### 1 Rengjør is og smussrester fra dørkarmen

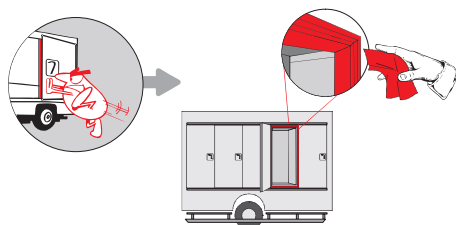

### 2 Spray gummipakninger

med Würth Silicone smøremiddel

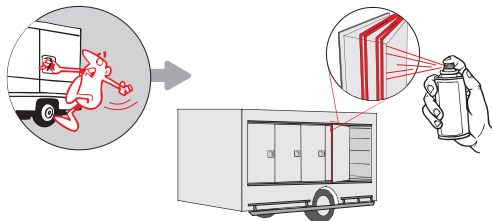

## HVER 3. MÅNED

### 1 Avrim fryserrommet

### 2 Smøres

med Würth Foodstuffs smøremiddel

#### a) Dørlåser og skruer

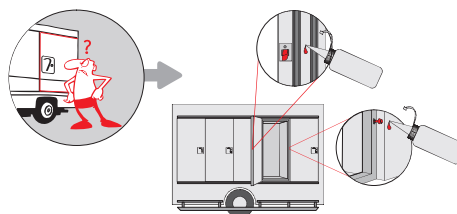

#### b) Låsesylindre

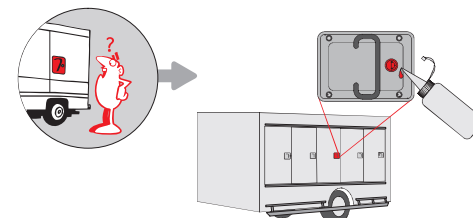

#### c) Sentral lås og andre bevegelige deler

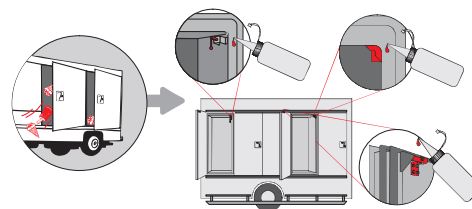

■ – Würth Silikonspray, Art. Nr. 0893221 (eller tilsvarende fra en annen produsent) anbefales.

■ – Würth Foodstuffs HHS, Art. Nr. 08931076 (eller tilsvarende fra en annen produsent) anbefales.

Carlsen Baltic UAB  
Salg. Service. Reservedeler.

\ T: +370 37 407343 \ info@carlsenbaltic.com \ carlsenbaltic.com



# Carlsen Baltic

## KAHDESTI VIIKOSSA

### Poista jää eutektisen levyn pinnalta

Käytä muovista jääkaavinta. Älä koskaan anna jääkerroksen paksuuntua yli 20 mm.

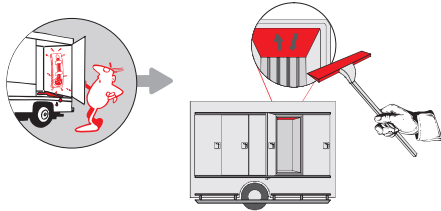

## KUUKAUSITTAIN

### 1 Puhdista jää- ja likajäämät ovikehyksestä

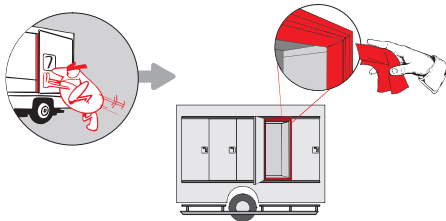

### 2 Suihkuta tiiviste

voiteluaineella ■

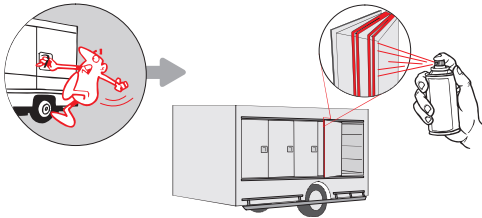

## JOKA 3 KUUKAUSI

### 1 Sulata kylmäkuljetusauto

### 2 Voitele

voiteluaineella ■

#### a) Oven lukko ja ruuvi

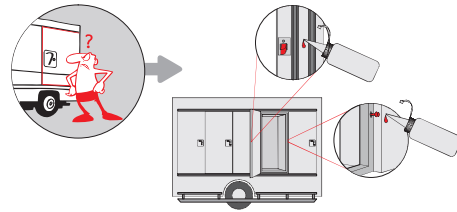

#### b) Lukkosylinteri

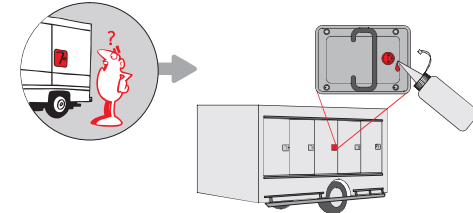

#### c) Keskuslukko (liikkuvat osat)

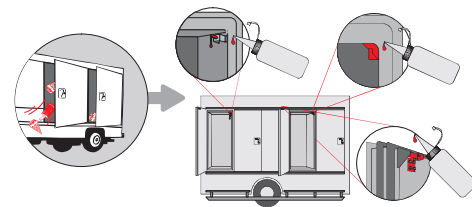

■ Würth silikonispray nro: 0893221 (tai vastaava) on suositeltavaa.

■ Würth HHS Foodstuffs voiteluaine nro: 08931076 (tai vastaavaa) on suositeltavaa.

**Carlsen Baltic UAB**  
Myynti. Palvelu. Varaosat.

\ T: +370 37 407343 \ info@carlsenbaltic.com \ carlsenbaltic.com





# Carlsen Baltic

## TWEE KEER PER WEEK

### Verwijder het ijs van het oppervlak van de eutectische plaat

Gebruik een plastic ijskrabber. Laat de ijslaag nooit meer dan 20 mm dik worden.

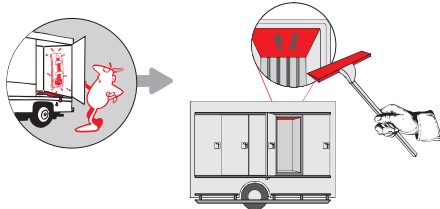

## EENS PER MAAND

### 1 Verwijder ijs en vuilresten van de deurframes

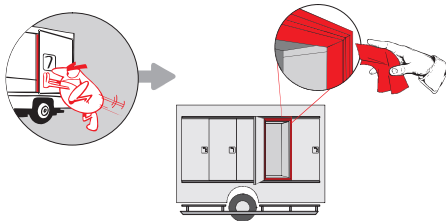

### 2 Spuit de deurrubbers in

Gebruik smeermiddel ■

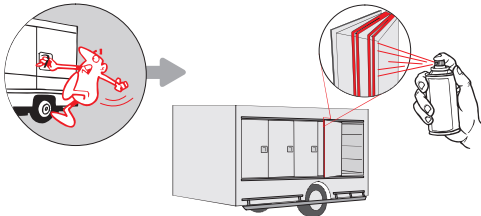

## ELKE DRIE MAANDEN

### 1 Ontdooi de koelopbouw

### 2 Smeer

Gebruik smeermiddel ■

#### a) Deursloten en sluitdelen

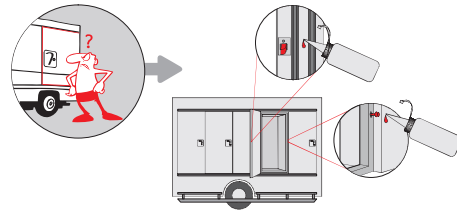

#### b) Cilindersloten

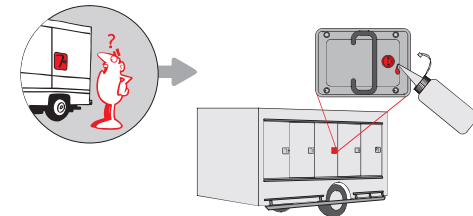

#### c) Centrale vergrendeling (bewegende delen)

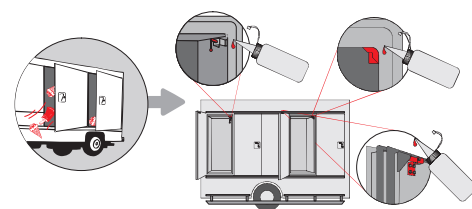

■ Würth Silicone Spray, art.-nr. 0893221 (of gelijkwaardig) wordt aanbevolen.

■ Würth Foodstuffs HHS, art.-nr. 08931076 (of gelijkwaardig) wordt aanbevolen.

**Carlsen Baltic UAB**  
Verkoop. Service. Reserveonderdelen.

T: +370 37 407343 | [info@carlsenbaltic.com](mailto:info@carlsenbaltic.com) | [carlsenbaltic.com](http://carlsenbaltic.com)



# Carlsen Baltic

## DOS VECES POR SEMANA

### Quite el hielo de la superficie de la placa eutéctica

Utilice una rasqueta de plástico para hielo. Nunca deje que la capa de hielo tenga más de 20 mm de espesor.

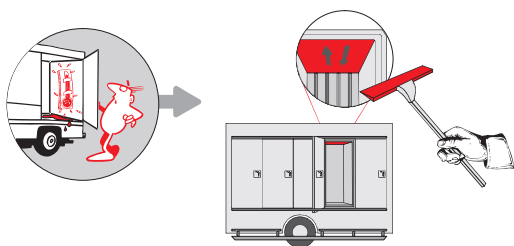

## MENSUALMENTE

### 1 Limpie el hielo y los residuos del marco de la puerta

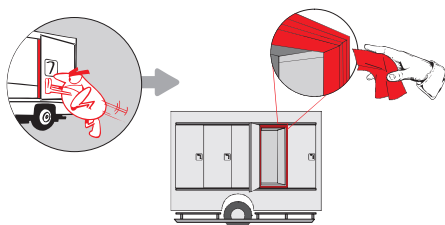

### 2 Lubricar las gomas de las puertas

Utilizando spray lubricante ■

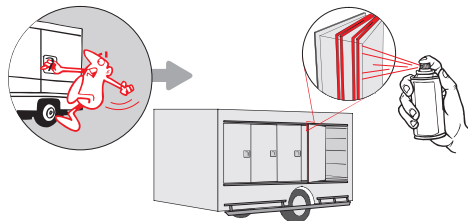

## CADA TRES MESES

### 1 Descongele la caja

### 2 Lubricar

Utilizar lubricante ■

#### a) Cerraduras puertas y tornillos

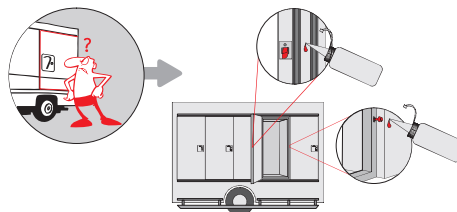

#### b) Bombillos de seguridad

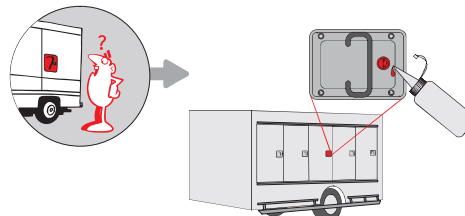

#### c) Cierre centralizado (partes móviles)

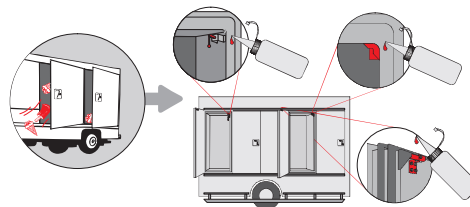

■ – Wurth Silicone Spray No. 0893 221 (o equivalente de otro fabricante) es recomendado.

■ – Wurth Foodstuffs HHS No. 0893 107 6 (o equivalente de otro fabricante) es recomendado.

Carlsen Baltic UAB \ T: +370 37 407343 \ info@carlsenbaltic.com \ carlsenbaltic.com



# Carlsen Baltic

2 DE DOUA ORI PE SAPTAMANA

## 1. Indepartati gheata de pe placile eutectice

Folositi o racleta de plastic. Nu lasati stratul de gheata sa depaseasca grosimea de 20 mm.

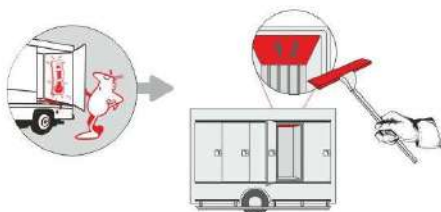

LUNAR

## 1. Curatati gheata sau murdaria de pe ramele usilor

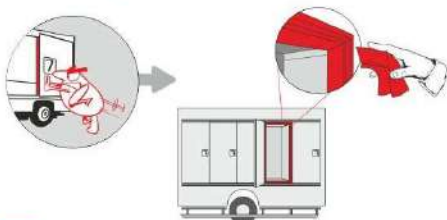

## 2. Spreiati garniturile

Folositi lubrifiant ■

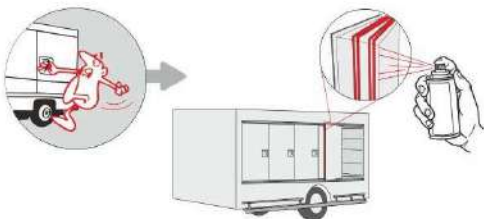

LA FIECARE 3 LUNI

## 1. Dezghetati suprastructura frigorifica

## 2. Gresati

Folositi lubrifiant ■

### a) Inchizatorile si bolturile

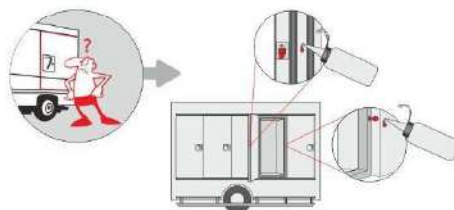

### b) Butucii incuietorilor

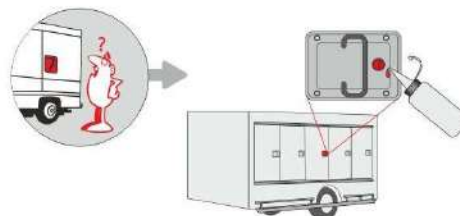

### c) Partile mobile ale incuietorii centralizate

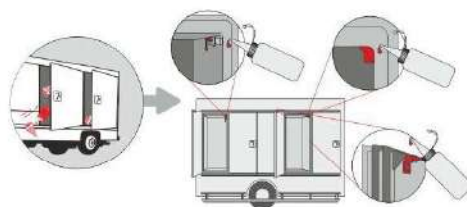

■ Würth Silicon Spray No. 0893221 (sau echivalent) este recomandat.

■ Würth Foodstuffs HHS No. 08931076 (sau echivalent) este recomandat.

**Carlsen Baltic UAB**  
Vanzari. Service. Piese de schimb.

\ T: +370 37 407343 \ [info@carlsenbaltic.com](mailto:info@carlsenbaltic.com) \ [carlsenbaltic.com](http://carlsenbaltic.com)



# Carlsen Baltic

## 2 RAZY W TYGODNIU

### Usuń lód z powierzchni płyt eutektycznych

Użyj plastikowej skrobaczki do lodu. Nigdy nie dopuść, aby grubość pokrywy lodowej przekroczyła 20 mm.

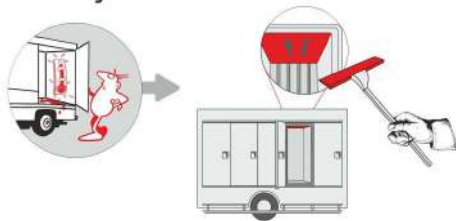

## RAZ W MIESIĄCU

### 1 Usuń lód i zanieczyszczenia z uszczelki i obramowania drzwi

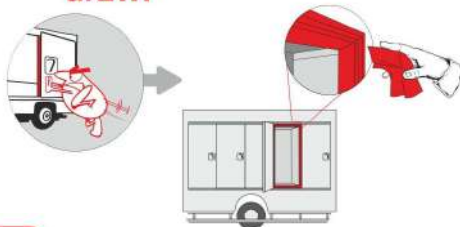

### 2 Spryskaj uszczelki drzwi

Smarem w sprayu ■

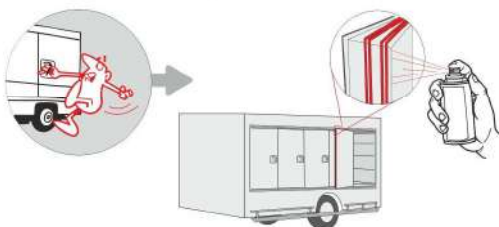

## CO 3 MIESIĄCE

### 1 Rozmroź zabudowę

### 2 Smaruj

Smarem ■

#### a) Zamki drzwi i zaczepy

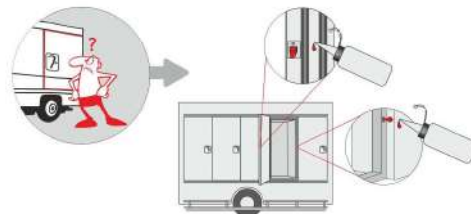

#### b) Cylinder zamykający (wkładkę kluczyka)

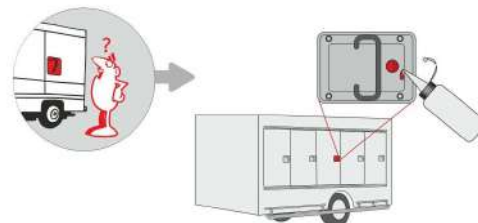

#### c) Centralny zamek (części ruchome)

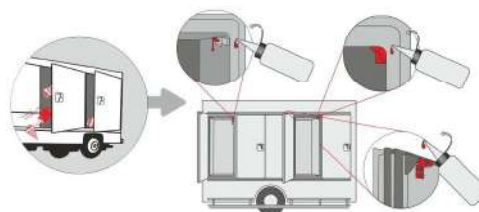

■ Würth silikon w sprayu nr art. 0893221 (lub równoważnego smaru) jest zalecane.

■ Würth Foodstuffs HHS nr art. 08931076 (lub równoważnego smaru) jest zalecane.

**Carlsen Baltic UAB**  
Sprzedaż. Serwis. Części zamienne.

\ T: +370 37 407343 \ info@carlsenbaltic.com \ carlsenbaltic.com



# Carlsen Baltic

## 2 KARTUS PER SAVAITĘ

### Nugrandykite ledą nuo eutektinių plokščių paviršiaus

Naudokite plastikinį ledo grandiklį. Neleiskite susidaryti storesniam nei 20 mm šerkšno sluoksniui.

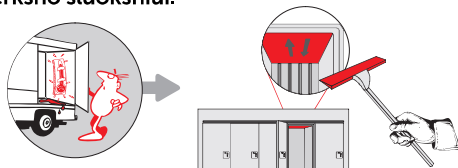

## KARTĄ PER MĖNESĮ

### 1 Nuvalykite ledą ir purvą nuo durelių rėmų

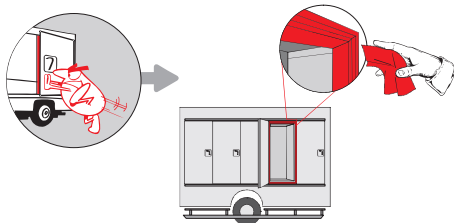

### 2 Sutepkite durelių tarpines

naudodami silikoninį tepalą

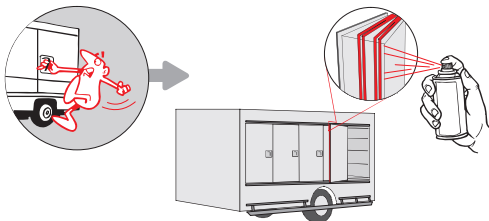

## KAS 3 MĖNESIUS

### 1 Atitirpinkite transportinį šaldytuvą

### 2 Sutepkite

naudodami alyvą

#### a) Durelių spynas ir varžtus

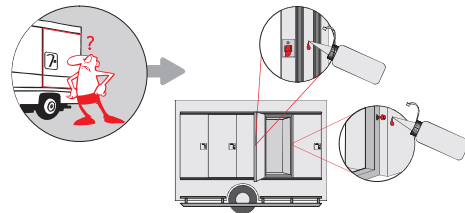

#### b) Užrakto cilindrus

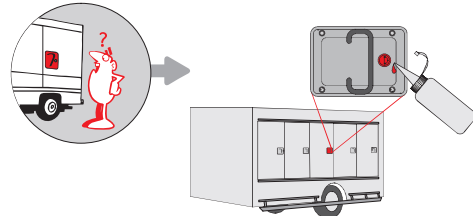

#### c) Centrinį užraktą (judančias dalis)

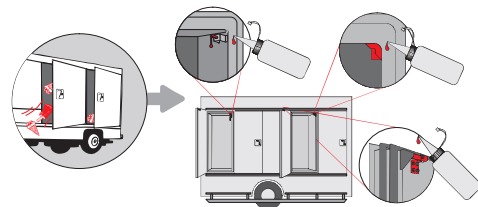

– rekomenduojame Würth purškiamąjį silikoną Nr. 0893 221 (arba jo atitikmenį).

– rekomenduojame Würth maisto pramonei skirtą alyvą HHS Nr. 0893 107 6 (arba jos atitikmenį).

**Carlsen Baltic UAB**  
Pardavimai. Servisas. Atsarginės dalys.

\ T: +370 37 407343 \ info@carlsenbaltic.com \ carlsenbaltic.com